

No. 3110

Royal Patent

GRANT.

KALAKAUA, By the Grace of God, King of the Hawaiian Islands:

By this His Royal Patent, makes known to all men, that he hath, for himself, his heirs and successors, this day granted and given unto

A. A. Montana

for the consideration of Four Hundred and Seventy three (473) Dollars paid into the Royal Exchequer, all that piece of Land situate at

Kaluapalapa, Kalaiki, Honolulu in the Island of Oahu and described as follows:

Beginning at Point A Angle N 67° 37' being the North angle of intersecting roads as shown by Government Survey of Kaluapalapa, thence running by these bearings:
N 88° 16' 50" to 500 feet
N 20° 44' 49" to 100 feet
S 67° 24' 44" to 197 7/10 feet
S 25° 16' 29" to 100 feet

Waihana
COPY

*Cancelled
Consideration not paid
A. A. Montana*

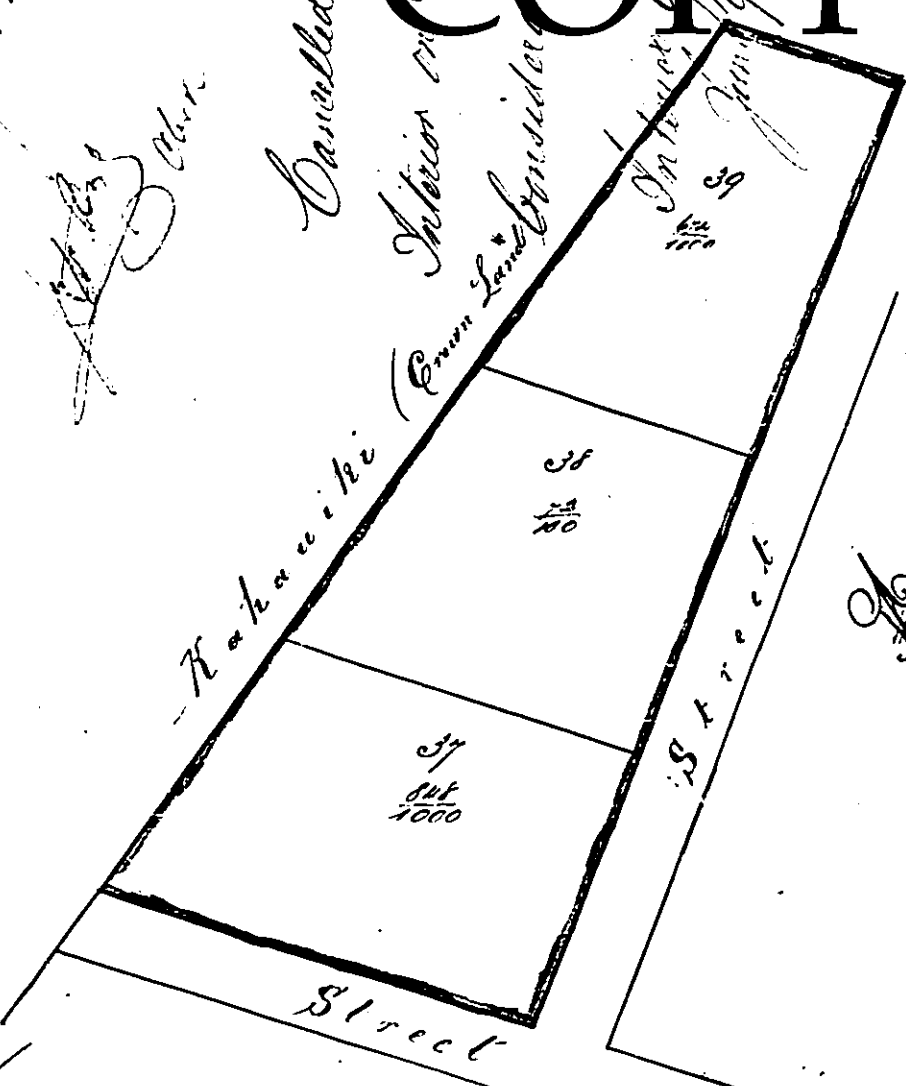

*Cancelled by order of His Majesty the King
Submitted to the King for consideration*