

ROYAL PATENT.

GRANT

Liliuokalani, By the Grace of God, Queen of the Hawaiian Islands:

By this Her Royal Patent makes known to all men, that She hath for herself, her heirs and successors, this day granted and given unto

*for the consideration of
paid into the Royal Exchequer, all that piece of Land situate at
in the Island of
and described as follows:*

*Beginning at a point on the south side of new road, on the
makai boundary of this Award, from which Hauiki A bears*

<i>N. 47° 55' N. True 1246 feet and running</i>	
<i>N. 55° 20' E. True 70 ft. along line of new road.</i>	
<i>N. 80° 30' E. " 270 " " " " " " "</i>	<i>waihona</i>
<i>N. 62° 45' E. " 50 " " " " " " "</i>	
<i>S. 25° 30' E. " 24 " " " " " " "</i>	<i>cross old road.</i>
<i>S. 77° 45' N. " 130 " " " " " " "</i>	<i>along south side of old road.</i>
<i>S. 75° 00' N. " 240 " " " " " " "</i>	
<i>N. 25° 30' N. " 15 " " " " " " "</i>	<i>to the initial point.</i>

COPY

13/100 Acres.

*Cancelled Exchange and
Certificate*

*Cancelled,
These maps of survey contain
mistake.
June 29. 1891*

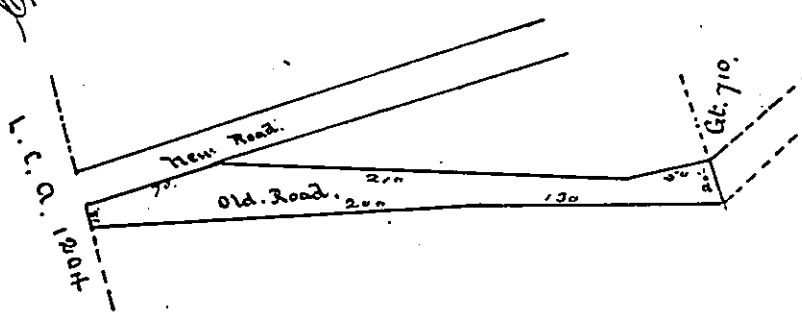

Sc. 100ft. = 1 inch.