

ROYAL PATENT.

GRANT

See Page 625

Liliuokalani, By the Grace of God, Queen of the Hawaiian Islands:

By this Her Royal Patent makes known to all men, that She hath for herself, her heirs and successors, this day granted and given unto

Jerry Boughlin

for the consideration of One Hundred and Ninety (\$190.) Dollars paid into the Royal Exchequer, all that piece of Land situate at

Kaluapalena — Kalihi — in the Island of

Oahu — and described as follows:

Lot 16.

Beginning at East corner of this Lot at a point 110 ft from the corner of Rose and Motley Streets and running as follows.

1. S. 45° 00' W. true 37.5 ft. to Lot 15.
2. N. 46° 16' W. " 110.3 " to Kalihi
3. N. 48° 00' E " 367.7 " to Lot 17.
4. S. 42° 00' E " 117.0 " to Rose Street to initial point

and containing an area of 95 1/2 Acres.

waihona
COPY

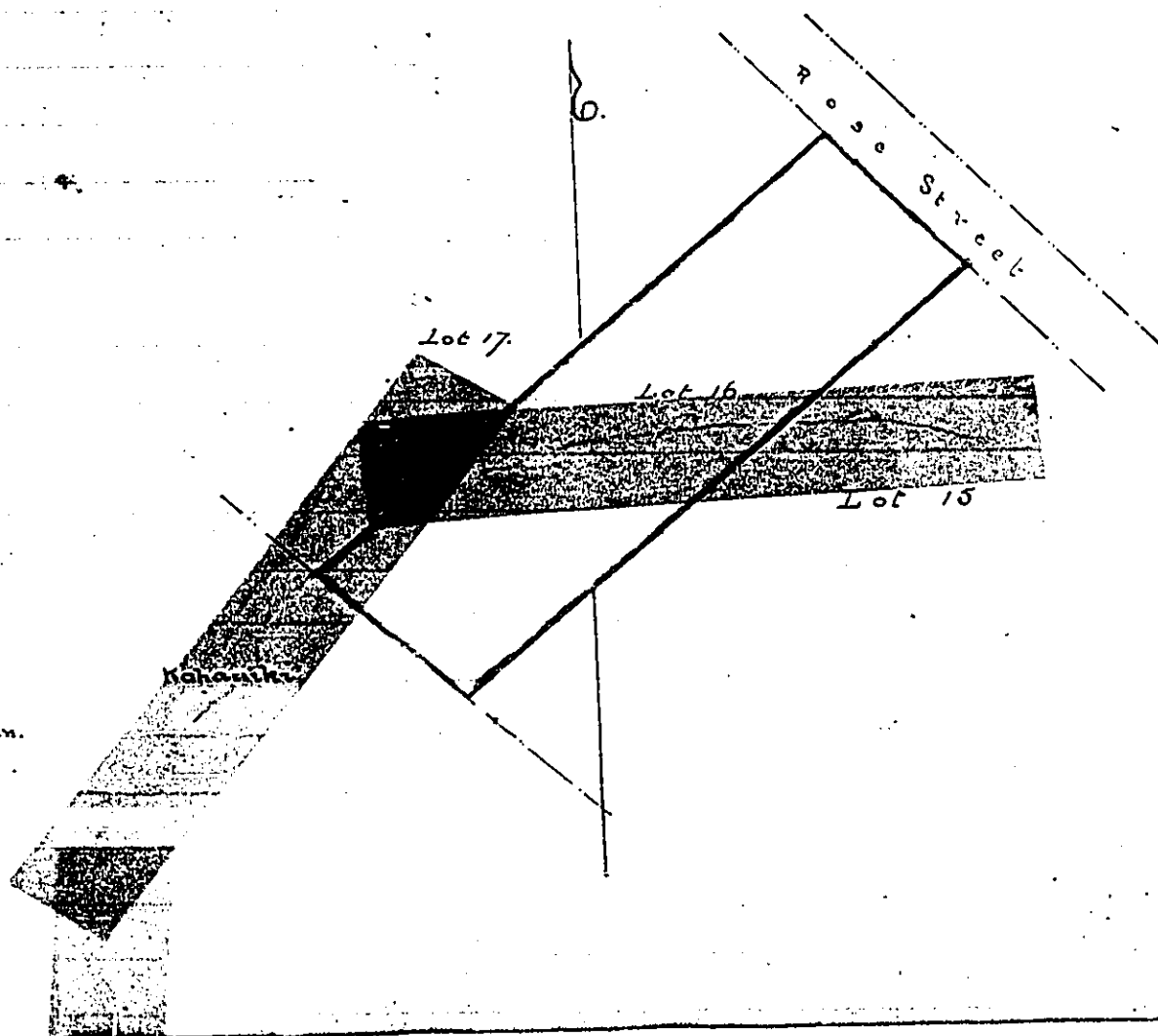

Scale. 100ft. = 1in.