

ROYAL PATENT.

GRANT.

Kaliuokalani, By the Grace of God, Queen of the Hawaiian Islands:

Its Hawaiian Government
 By this ~~Her Royal~~ Patent, makes known to all men, that ~~She~~ *It*
~~for herself, her heirs and successors,~~ this day granted and given unto

Frank Gomes

for the consideration of Six Hundred⁹⁰ Ninety (690⁹⁰) Dollars
 paid into the Royal Exchequer, all that piece of Land situate at
South Slope Punchbowl Hill Honolulu in the Island of
Oahu and described as follows:

Lot 72-519

Beginning at a point on mauka side of Spencer Ave, 110.15 feet
 North west of the concrete Post at the North corner of Spencer
 Avenue and Hackfeld St. and running:-

- N. 52° 30' W. True 111.85 feet along the mauka side of Spencer Ave
- N. 37° 30' E " 116.44 ~~feet~~ land
- S. 30° 40' E " 39.0 Ditch reservation
- S. 63° 56' E " 77.4 "
- S. 37° 30' W " 117.5 lot 51 to the initial point.

Area 13100 Square Feet.

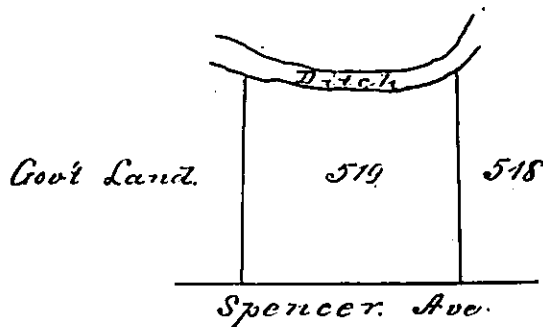

waihona
COPY