

ROYAL PATENT.

GRANT.

Liliuokalani, By the Grace of God, Queen of the Hawaiian Islands:

By this ~~Her Royal~~ Patent, *The Hawaiian Government* makes known to all men, that ~~She~~ *It* hath for herself, her heirs and successors, this day granted and given unto

Manoel dos Santos

for the consideration of One Hundred and Eighty Nine (189) Dollars paid into the Royal Exchequer, all that piece of Land situate at
Ahualoa Hanalei in the Island of
Hawaii and described as follows:

Lot 4

Beginning at N. E. L. at road which point is South 700 feet East 59.85 "

from Govt Survey @ *Waihona* thence the boundary runs by true bearings:-

- S. 69° 00' W. 144 feet ~~along road~~ -----
- N. 55° 10' W. 267 "
- S. 84° 40' W. 101 "
- S. 44° 55' W. 1865 " Lot 5
- S. 85° 05' E. 460 " Lot 44 of Map 18.
- N. 44° 55' E. 1815 " Lot 3 to Initial point.

COPY

Area 18 7/10 Acres

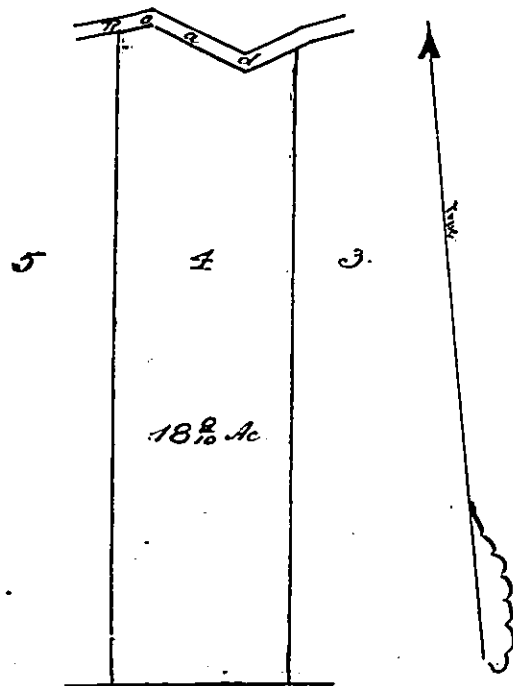

Scale 500ft = 1 inch.