

ROYAL PATENT.

GRANT.

Piliuhalani, By the Grace of God, Queen of the Hawaiian Islands:

Its The Government of the Republic of Hawaii *It has*
By this ~~Her~~ Royal Patent, makes known to all men, that ~~She~~ hath
for herself, her heirs and successors, this day granted and given unto

H. M. Dow

for the consideration of Four Hundred and Thirty (\$430⁰⁰) Dollars
paid into the ~~Royal~~ Exchequer, all that piece of Land situate at
South Slope Punchbowl Hills, Honolulu in the Island of
Oahu and described as follows:

Lot No 603

Beginning at a point on the marked side of Spencer Avenue
364 feet West of the North corner of Spencer Avenue and Government
Reservation for street along the West side of Makiki Cemetery as
shown on Government survey Reg. No. 1749 and running—
S. 76° 15' W. line 121.3 feet ~~along Spencer Avenue~~

- N. 13° 45' W. " 244.0 " *Government Land.*
- N. 73° 30' E. " 121.3 " **COPY**
- S. 13° 45' E. " 249.0 " Lot 603 to the initial point.

Area 29900 Square Feet.

N. Meridian.

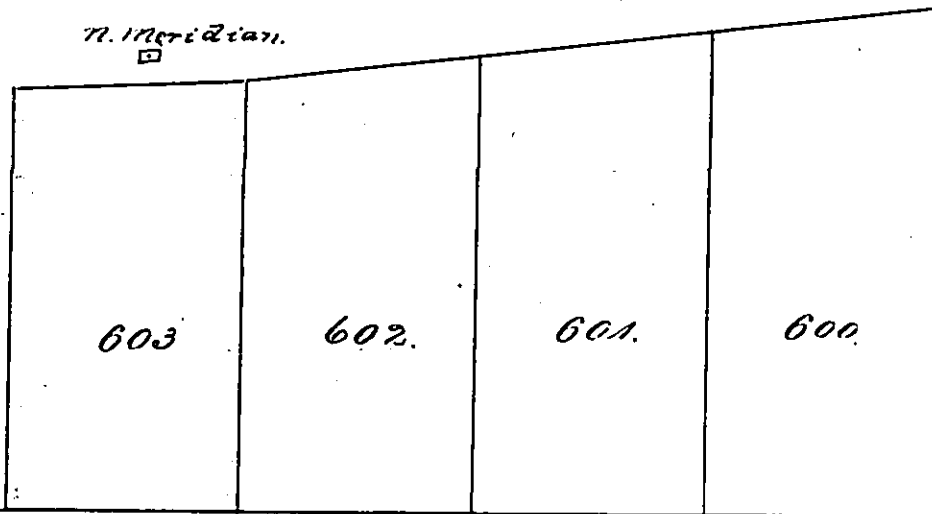

Spencer Avenue.

DR. C. B. Wood.

Street.

Makiki Cemetery

Thurston Avenue.